

PRODUCT SPECIFICATION

Seat post clamp QR or Bolt-On versions

Available sizes:

Ø28.6 | Ø30.0 | Ø31.8 | Ø33.4

Ø34.9 | Ø36.4 | Ø38.5 | Ø39.7

TOOLS REQUIRED

- 4mm Hex

PRELIMINARY CHECKS

Make sure you have the correct clamp size for your frame. Measure the diameter of the seat tube on your frame, **not the diameter of the seatpost!**

You can also generally find the dimension of the required seat post clamp on your bike manufacturer's website. The frame tube size should be within +/-0.5mm compared to the nominal clamp size.

INSTALLATION

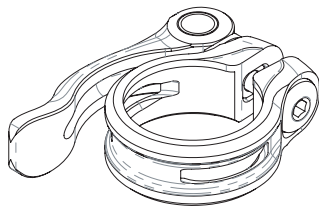

QR Type:

- Loosen the screw and open the lever.
- If you are replacing an existing clamp and using an internal routed dropper seatpost, remove the screw entirely so you can thread in the dropper cable guide then re-install the screw.
- Install the clamp making sure the lip is resting **on the top** of the frame seat tube.
- Align the slot of the seat post clamp on the opposite side of the slot of the frame.
- Close the lever.
- Set the seatpost at the required height.
- Using a 4mm Hex tighten the screw up to the recommended tightening torque of **5N.m**
- If using a dropper seatpost make sure it is moving up and down freely. You may need to reduce tightening torque if not.

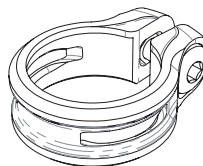

Bolt-On Type:

- Loosen the screw.
- If you are replacing an existing clamp and using an internal routed dropper seatpost, remove the screw entirely so you can thread in the dropper cable guide then re-install the screw.
- Install the clamp making sure the lip is resting **on the top** of the frame seat tube.
- Align the slot of the seat post clamp on the opposite side of the slot of the frame.
- Set the seatpost at the required height.
- Using a 4mm Hex tighten the screw up to the recommended tightening torque of **6N.m**
- If using a dropper seatpost make sure it is moving up and down freely. You may need to reduce tightening torque if not.

INST051_EN: Instruction - Seat Clamps

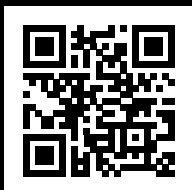

Traduction Française
Deutsche Übersetzung

HOPETECH.COM

SEAT CLAMPS

hope