

SPIDERLESS CHAINRING RR: E-BIKE BO

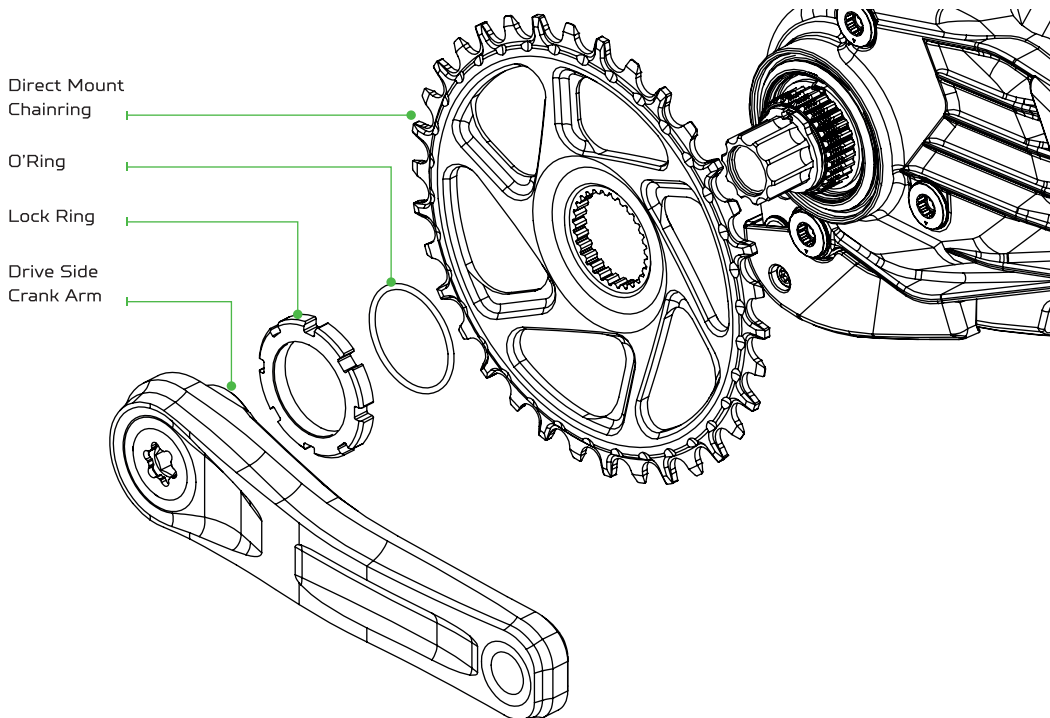

INSTALLATION

- This chainring is compatible with the Bosch Performance Line CX 2020 onwards (Gen 4) motor.
- Hope chainring is direct fit for a 52mm BOOST chain line.
- Please refer to the relevant **manufacturer instructions** for removal and installation of cranks and spiders/chainrings.
- This exploded view is provided as an assembly reference.
- It is recommended to fit a new Bosch O'ring when replacing chainring [Bosch #1270016119](#)
- Park Tool BBT-18 or equivalent is required for removal/installation of the spider locking.

INST013_EN: Instruction - Ebike spiderless chainring BO - V1



E.BIKE CHAINRINGS

[E.BIKE BO VERSION]

