

## 2013 HOPE Technology 1x IBR Chainring - Installation instructions

### INTRODUCTION

Congratulations, you have just acquired an HOPE TECHNOLOGY chainring with Integrated Bash Ring (IBR) proudly designed, made and tested in our Barnoldswick factory in the United Kingdom.  
This item is a chainring with a bash guard built in, saving some substantial weight against a classic chainring plus bash setup. This 1x IBR chainring is perfect to be used with one of our 1x chainguide offerings.

### BOX CONTENTS & TOOLS REQUIRED

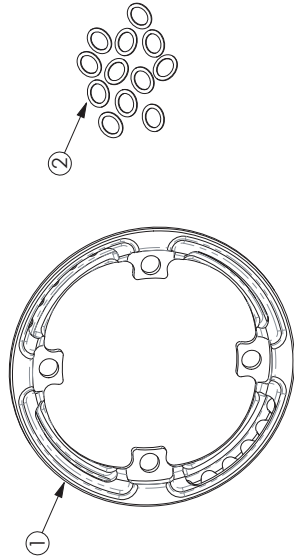

- 1- IBR chainring (104BCD shown)
- 2- set of 12 0.5mm thick shim

Tool required :  
- Chaining removal tools (usually 5mm Allen key)

### INSTALLATION

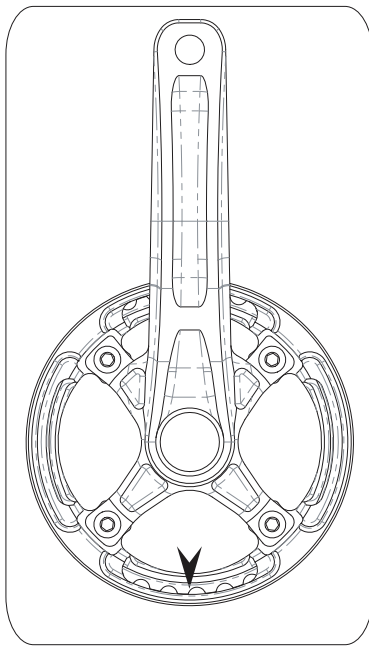

1. On a clean crankset, remove older chainring if present.
2. Keep the chainring bolts aside. Clean and grease threads and surface under bolt head.
3. Install the IBR chainring in the middle chainring position or best position for optimum chainline.  
The IBR chainring must be installed so the thinner wall section of the bash ring is aligned with the crank arm (see arrow on drawing). If needed, you can use the 0.5mm shims provided should you need to adjust the chainring position or space out the chainring bolts.
4. Re-install the chainring bolts and tighten them alternately following crankset manufacturer specification.  
Usually 9Nm of torque for alloy bolts and 11Nm for stainless steel bolts.  
There should be no side play of the chainring at all when all bolts are tightened.
5. Go for a test ride.

### WARRANTY

All Hope Technology components are covered for one year from original date of purchase against manufacturer defects in material and workmanship. Proof of purchase is required. Products must be returned to the original place of purchase or to Hope Technology to process any warranty claim. Please print and fill the "goods returned form" found on the tech support section of our website should you wish to send a product back. This warranty does not cover any damage caused through mis-use or failing to comply by the recommendations given in this manual. This warranty does not affect your statutory rights.

## 2013 HOPE Technology 1x IBR Chainring - Installation instructions

### INTRODUCTION

Congratulations, you have just acquired an HOPE TECHNOLOGY chainring with Integrated Bash Ring (IBR) proudly designed, made and tested in our Barnoldswick factory in the United Kingdom.  
This item is a chainring with a bash guard built in, saving some substantial weight against a classic chainring plus bash setup. This 1x IBR chainring is perfect to be used with one of our 1x chainguide offerings.

### BOX CONTENTS & TOOLS REQUIRED

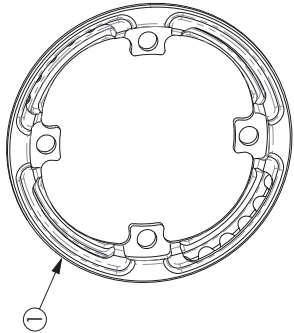

- 1- IBR chainring (104BCD shown)
- 2- set of 12 0.5mm thick shim

Tool required :  
- Chaining removal tools (usually 5mm Allen key)

### INSTALLATION

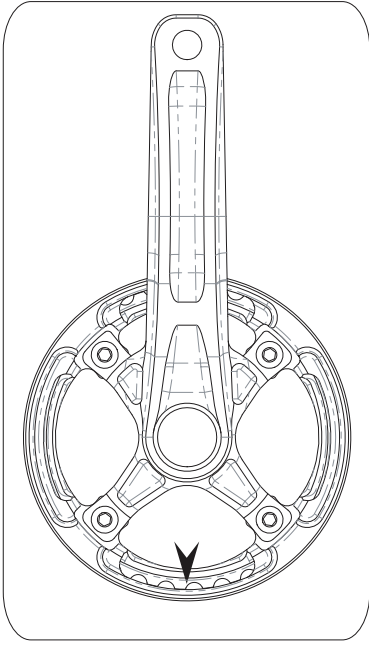

1. On a clean crankset, remove older chainring if present.
2. Keep the chainring bolts aside. Clean and grease threads and surface under bolt head.
3. Install the IBR chainring in the middle chainring position or best position for optimum chainline.  
The IBR chainring must be installed so the thinner wall section of the bash ring is aligned with the crank arm (see arrow on drawing). If needed, you can use the 0.5mm shims provided should you need to adjust the chainring position or space out the chainring bolts.
4. Re-install the chainring bolts and tighten them alternately following crankset manufacturer specification.  
Usually 9Nm of torque for alloy bolts and 11Nm for stainless steel bolts.  
There should be no side play of the chainring at all when all bolts are tightened.
5. Go for a test ride.

### WARRANTY

All Hope Technology components are covered for one year from original date of purchase against manufacturer defects in material and workmanship. Proof of purchase is required. Products must be returned to the original place of purchase or to Hope Technology to process any warranty claim. Please print and fill the "goods returned form" found on the tech support section of our website should you wish to send a product back. This warranty does not cover any damage caused through mis-use or failing to comply by the recommendations given in this manual. This warranty does not affect your statutory rights.